

Please read and save these instructions. Read through this owner's manual carefully before using product. Protect yourself and others by observing all safety information, warnings, and cautions. Failure to comply with instructions could result in personal injury and/or damage to product or property. Please retain instructions for future reference.



3 POINT ENGINE SUPPORT BAR

FOR CUSTOMER SERVICE

Technical Question?

CALL 1-866-458-2472
customerservice@oem-tools.com

UNPACKING

After unpacking the unit, inspect carefully for any damage that may have occurred during transit. Check for loose, missing, or damaged parts. If any damage is observed, a shipping damage claim must be filed with the carrier. DO NOT use the OEMTOOLS® 24951 3 Point Engine Support Bar if broken, bent, cracked or damaged parts (including labels) are noted. Any Engine Support Bar that appears damaged in any way, operates abnormally or is missing parts should be removed from service immediately. If you suspect that the Engine Support Bar was subjected to shock load (a load that was dropped suddenly, unexpectedly, etc.), immediately discontinue use until it has been checked by a factory authorized service center.



⚠ WARNING

The following safety information is provided as a guideline to help you operate your 3 Point Engine Support Bar under the safest possible conditions. Any tool or piece of equipment can be potentially dangerous to use when safety or safe handling instructions are not known or not followed. The following safety instructions are to provide the user with the information necessary for safe use and operation. Please read and retain these instructions for the continued safe use of your Engine Support Bar. Failure to follow instructions listed below may result in serious injury. In addition, make sure that anyone who uses the equipment understands and follows these safety instructions as well.

Explanation of Safety Signal Words

⚠ WARNING: Indicates a potentially hazardous situation which, if not avoided, could result in death or serious injury.

⚠ CAUTION: Indicates a potentially hazardous situation which, if not avoided, may result in minor or moderate injury.

CAUTION: Used without the safety alert symbol indicates a potentially hazardous situation which, if not avoided, may result in property damage.

NOTES: Provide clarity and helpful information.

Thank you very much for choosing an OEMTOOLS® Product!

For future reference, please register your new tool at www.oem-tools.com and complete the owner's record below:

Model: _____ **Purchase Date:** _____

Save the receipt, warranty and these instructions. It is important that you read the entire manual to become familiar with this product before you begin using it. This product is designed for certain applications only. OEMTOOLS® cannot be responsible for issues arising from modification. We strongly recommend that this product is not modified and/or used for any application other than that for which it was designed. If you have any questions relative to a particular application, DO NOT use the product until you have first contacted customer service to determine if it can or should be performed on the product.

⚠ WARNING: This product can expose you to chemicals which are known to the State of California to cause cancer and birth defects or other reproductive harm. For more information go to www.P65Warnings.ca.gov.



3 POINT ENGINE SUPPORT BAR

! IMPORTANT INSTRUCTIONS AND SAFETY RULES

1. Know your product. Read this manual carefully. Learn the product's applications and limitations, as well as potential hazards specific to it. The use of this product is simple and straightforward if you follow the instructions. When operating this product, use common sense and only use this product for its intended purpose.
2. Maintain labels and nameplates on this product. These carry important information. If unreadable or missing, contact OEMTOOLS® for a replacement.
3. Maintain this product with care. Keep it dry and clean – and free from brake fluid, oil, and grease (if applicable).
4. Check for damage. Check your product regularly. If part of the product is damaged, it should be carefully inspected to make sure that it can perform its intended function correctly. If in doubt, the part should be repaired. Refer all servicing to a qualified technician. Consult your dealer for advice.
5. Check for misalignment or binding of moving parts, breakage of parts, and any other condition that may affect the product's operation.
6. DO NOT use a damaged product. Tag damaged products "DO NOT USE" until repaired. If damaged, have the product serviced before using. Many accidents are caused by poorly maintained products.
7. Service must be performed only by qualified repair personnel. Service or maintenance performed by unqualified personnel could create a risk of injury.
8. When servicing a product, use only identical replacement parts. Use of unauthorized parts or failure to follow maintenance instructions could create a risk of injury.
9. Use only accessories that are recommended by the manufacturer for your model. Accessories that may be suitable for one product may become hazardous when used on another product.
10. Keep work area clean and well lit. Cluttered or dark work areas invite accidents.
11. Maintain a safe working environment. Keep the work area well lit. Make sure there is adequate surrounding workspace. Keep the work area free of obstructions, grease, oil, trash, and other debris. DO NOT use this product in a damp or wet location.
12. Keep children away from the work area. Never let a child handle this product without strict adult supervision.
13. Store this product out of the reach of children and untrained persons. This product may be dangerous in the hands of untrained users.
14. DO NOT operate this product if under the influence of alcohol or drugs. Read warning labels on prescriptions to determine if your judgment or reflexes are impaired while taking drugs. If there is any doubt, DO NOT attempt to operate.
15. Use safety equipment. Eye protection should be worn at all times when operating this product. Use ANSI approved safety glasses. Everyday eyeglasses are NOT safety glasses. Dust mask, non-skid safety shoes, hard hat or hearing protection should be used in appropriate conditions.
16. Wear proper apparel. Loose clothing, gloves, neck-ties, rings, bracelets or other jewelry may present a potential hazard when operating this product. Keep all apparel clear of the product.
17. DO NOT overreach. Keep proper footing and balance at all times when operating this product.
18. Keep away from flammables. DO NOT attempt to operate this product near flammable materials or combustibles. Failure to comply may cause serious injury or death.
19. Avoid accidental fire and/or explosion. DO NOT smoke near engine fuel and battery components.
20. We believe the information contained herein to be reliable. However, general technical information is given by us without charge and the user shall employ such information at their own discretion and risk. We assume no responsibility for results or damages incurred from the use of such information in whole or in part. Always refer to specific instructions and technical information supplied by vehicle manufacturer.
21. The manufacturer declines any and all responsibility for property damage or injury if said damage is the result of unskillful handling by the operator or of failure to observe the basic safety rules set forth in the instruction manual.
22. The warnings, precautions, and instructions discussed in this manual cannot cover all possible conditions and situations that may occur. The operator must understand that common sense and caution are factors which cannot be built into this product, but must be supplied by the operator.

PRODUCT DESCRIPTION

The OEMTOOLS® 24951 3 Point Engine Support Bar is designed to safely support engines up to 700 Lb. It makes removal of the transaxle easy by supporting the engine of front wheel drive vehicles. The heavy duty steel frame helps prevent distortion and twisting.

PRODUCT SPECIFICATIONS

Maximum Capacity	700 Lb.
Maximum Spread	61"
Minimum Spread	38"
Hook Thread Length	12.5"
Shipping Weight	27.5 Lb.

CONTENTS

1. Engine Support Bar Assembly
2. Instruction Manual

SPECIFIC SAFETY INSTRUCTIONS AND WARNINGS

Thoroughly read and understand the provided product manual before attempting to use this product.

1. DO NOT exceed maximum load capacity (700 Lb.).
2. Ensure all lock knobs, nuts and bolts are tightened securely prior to applying load.
3. Prior to applying load, ensure the load is properly secured to the Engine Support Bar.
4. NEVER work under a lifted load.
5. DO NOT place fingers, hands or any part of the body under the lifted load, or between the load and another surface.



3 POINT ENGINE SUPPORT BAR

6. DO NOT attempt to modify the Engine Support Bar. This may impair the strength and balance of the bar, leading to product failure.
7. DO NOT move the vehicle, engine or engine supports while the Engine Support Bar is supporting the weight of the Engine.
8. DO NOT leave the engine suspended for long periods of time. This tool is intended for use during maintenance, not for engine storage.
9. ALWAYS inspect the Engine Support Bar before each use. Discontinue use immediately if the unit is bent, broken or damaged in any way.
10. Imbalanced loading, swinging or sudden drops can generate dynamic loading, which may lead to product failure.
11. Personal Protective Equipment: ALWAYS wear ANSI approved impact safety goggles, a full-face impact rated safety shield and heavy-duty work gloves while performing any vehicle maintenance or repair.

ASSEMBLY INSTRUCTIONS

1. Insert the wide leg (#13) into tube welded at the end of the boom (#1) and the narrow leg (#14) to boom extension (#2).
2. Slide transfer adapter (#11) over the end of boom extension (#2) with tube toward you.
3. Insert the boom extension (#2) into the boom (#1).

NOTE: The 3 Point Engine Support Bar may be used with or without support arm, depending on the load being supported.

4. To use without support arm: Secure both threaded hooks (#3) to the tube welded on boom and transfer adapter with barrel hex nut (#7). Thread the hex nut (#7) all the way down towards the hook portion to hold it out of the way until needed.
5. To use with support arm:
 - a. Insert the adjustable leg (#6) to support arm (#10), then hand tighten with M8x65 bolt and wing nut (#8 and #9). Do not fully tighten wing nut as height adjustment may be necessary once the Engine Support Bar is placed over the engine compartment of the vehicle.
 - b. After determining the length of support arm needed, connect the support arm (#10) to transfer adapter (#11) on the boom extension with M12x120 bolt and wing nut (#4 and #5). Again, do not fully tighten as some length adjustment may be required.
 - c. Before placing the Engine Support Bar over the engine compartment, install the two threaded hooks (#3) provided. Insert one hook to the tube welded on the boom (#1) and secure with barrel hex nut (#7). Thread the hex nut (#7) all the way down towards the hook portion to hold it out of the way until needed. Then locate the best position on the support arm for the second hook and install in the same manner.
6. Now the Engine Support Bar is ready to use.

OPERATION INSTRUCTIONS

▲WARNING: OEMTOOLS® is not responsible for damage to the vehicle or paint finish. The user must

understand that by using this product, they are accepting the risks involved with vehicle maintenance and repair. There are outlying factors that cannot be discussed or defined by this product manual. Always refer to the vehicle maintenance manual, and utilize best judgment prior to attempting any maintenance or repair.

1. Determine the location of the two engine support bolts on your vehicle. Then place the Engine Support Bar directly over these two bolts.
2. Adjust the boom extension (#2) to ensure that both legs (#13 and #14) are sitting inside the fender of the engine compartment.

▲CAUTION: If the inside fender lips are more than 61" apart, the Engine Support Bar must not be used. Do not extend past the designated marking (61") as overextending this unit may compromise the 700 lb. capacity. This could cause the Engine Support Bar to collapse, resulting in personal injury or property damage.

3. Adjust to ensure the support arm (#10) is in correct position. The rubber tip of the adjustable leg (#6) should be on a flat, reinforced surface capable of supporting the weight of the engine. Tighten both wing nuts (#4 and #8) to secure the adjustable leg (#6) and support arm (#10).
4. Lower the threaded hooks (#3) to appropriate position. Ensure that the hooks are directly over the engine support bolts or brackets; therefore the engine does not swing when vehicle is disassembled.
5. Attach the looped ends of the two 1/8" braided steel cables (#12) to the engine support bolts on the engine, and loop the middle of the braided cables over the hooks. If the engine being supported is equipped with engine lift brackets, hook the hooks (#3) directly into engine lift brackets for extra protection.

NOTE: Use only fasteners rated Grade 5 or higher as engine support bolts.

6. Tighten the barrel hex nuts (#7) on both hooks until cables are snug or hex nuts are tight against the support bar.
7. Double check that engine is properly supported before disassemble the vehicle.

PRODUCT STORAGE

Always store the Engine Support Bar in a well-protected area where it will not be exposed to inclement weather, corrosive vapors, abrasive dust, fire or any other harmful elements.

PRODUCT MAINTENANCE

Periodically inspect the Engine Support Bar. Ensure all parts move freely. To help prevent rust, wipe clean and/or blow dry after each use. If rust appears, sand affected area and cover with suitable utility paint. Store the Engine Support Bar in a clean, dry area.

DISPOSAL

At the end of the useful life of the OEMTOOLS® Engine Support Bar, dispose of the components in accordance with all federal, state and local regulations.



3 POINT ENGINE SUPPORT BAR

PRODUCT LAYOUT

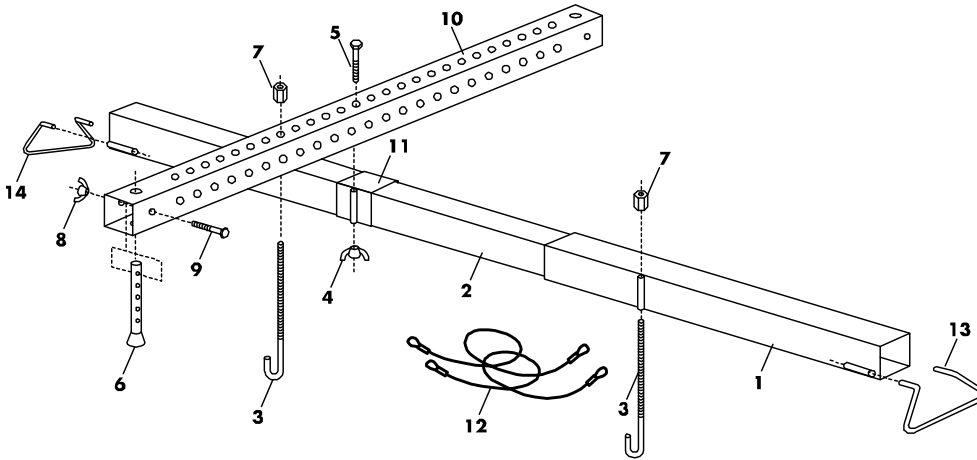

PARTS LIST

Figure	Description	Qty.
1	Boom	1
2	Boom Extension	1
3	Threaded Hook	2
4	Wing Nut, M12	1
5	Hex Bolt, M12x120	1
6	Adjustable Leg	1
7	Barrel Hex Nut	2
8	Wing Nut, M8	1
9	Hex Bolt, M8x65	1
10	Support Arm	1
11	Transfer Adapter	1
12	Braided Steel Cable	2
13	Wide Leg	1
14	Narrow Leg	1

WE STAND BEHIND OUR TOOLS. OEMTOOLS® LIMITED LIFETIME WARRANTY

For as long as you own this OEMTOOLS® product, if you find any defect in material or workmanship, through normal usage, return it to the place of purchase or to OEMTOOLS® for repair or replacement at our discretion. In order to obtain this service, send your tool and proof of purchase (transportation pre-paid) to:

OEMTOOLS® Q.A. Dept., 3580 E. Raines Road #3, Memphis, TN 38118.

We will not be responsible for lost or damaged goods during transportation; please insure your package. If our inspection verifies the defect, we will repair or replace the product, or we may elect to refund the purchase price if we cannot readily and quickly provide you with a replacement. We will return repaired products at our expense, but if we determine there is no defect, or that the defect resulted from causes not within the scope of our warranty, then you must bear the cost of returning the product.

OEMTOOLS® does not provide warranty for products labeled other than OEM® or OEMTOOLS®. OEMTOOLS® will not provide any warranty for products subjected to abnormal use. Abnormal use includes (but is not limited to) abuse, accident, alteration, neglect, and unauthorized or unreasonable use or repairs. This warranty does not cover bits, blades, files, batteries, or calibration. We recommend that you maintain your tools and sharpen or replace blades, bits, files, and batteries as necessary. OEMTOOLS® reserves the right to make any changes in construction or design at any time without any obligation in incorporating such changes to tools or equipment previously sold.

OEMTOOLS® makes every effort to ensure that its products meet high quality and durability standards, and warrants to the original purchaser that this product is free from defects in materials and workmanship. This warranty does not apply to damage due directly or indirectly to misuse, abuse, negligence or accidents, repairs or alterations outside our facilities, criminal activity, improper installation, normal wear and tear, or to lack of maintenance.

We shall in no event be liable for death, injuries to persons or property, or for incidental, contingent, special or consequential damages arising from the use of our product. Some states do not allow the exclusion or limitation of incidental or consequential damages, so the above limitation of exclusion may not apply to you. THIS WARRANTY IS EXPRESSLY IN LIEU OF ALL OTHER WARRANTIES, EXPRESS OR IMPLIED, INCLUDING THE WARRANTIES OF MERCHANTABILITY AND FITNESS. This warranty gives you specific legal rights, and you may also have other rights, which vary from state to state.

Please contact us at customerservice@oem-tools.com or call us at 901-370-1101 for additional information or questions.

Thank you for your purchase.

CONTACT US

3580 E. Raines Road, Suite 3, Memphis, TN 38118
 Tel: 1-866-458-2472
 www.oem-tools.com

